

Z Fittings

FITTINGS

This section offers a full selection of fittings and accessories to complete metal framing system. Fittings are made from hot rolled, pickled and oiled plate or strip steel in accordance with ASTM A1018 33,000 PSI min. yield, unless noted.

Dimensions

The following dimensions apply to all fittings except as noted:

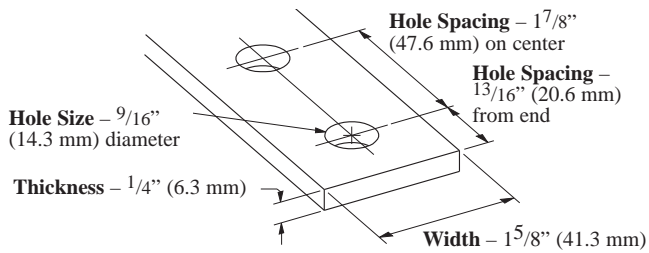

Materials & Finishes (Unless otherwise noted)

Finish Code	Finish	Specification
PLN	Plain	ASTM A1018 33,000 PSI min. yield
ZN	Electro-Plated Zinc	ASTM B633 SC3 Type III
GRN	Dura-Green	TT-C-490B
HDG	Hot-Dipped Galvanized	ASTM A123
SS4	Stainless Steel Type 304	ASTM A240
SS6	Stainless Steel Type 316	ASTM A240

Note: A minimum order may apply on special material and finishes.

Recommended Bolt Torque

Bolt Size	$\frac{1}{4}$ "-20	$\frac{5}{16}$ "-18	$\frac{3}{8}$ "-16	$\frac{1}{2}$ "-13
Foot/Lbs.	6	11	19	50
Nm	8	15	26	68

Z-FITINGS

P526
TWO HOLE
OFFSET Z-SUPPORT

•Standard finishes: ZN, GRN

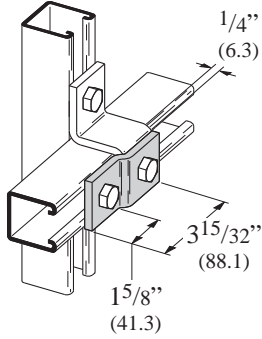

P106-52
TWO HOLE
Z-SUPPORT FOR B52

•Standard finishes: ZN, GRN

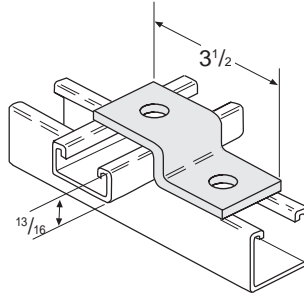

P106-42
TWO HOLE
Z-SUPPORT FOR B42

•Standard finishes: ZN, GRN

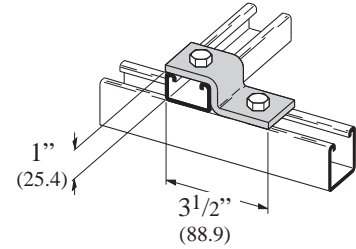

P106-32
TWO HOLE
Z-SUPPORT FOR B32

•Standard finishes: ZN, GRN

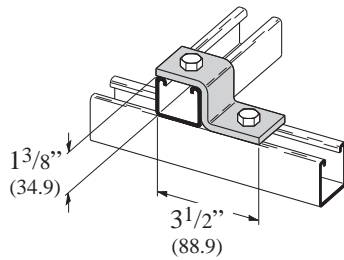

P106-12
TWO HOLE
Z-SUPPORT FOR B12

•Standard finishes: ZN, GRN

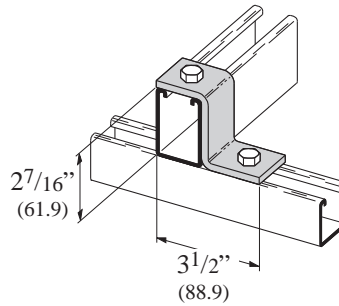

P105
THREE HOLE
Z-SUPPORT FOR B22

•Standard finishes: ZN, GRN, HDG

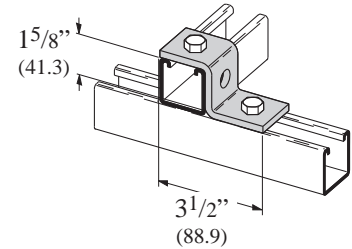

P110
THREE HOLE
Z-SUPPORT FOR B11

•Standard finishes: ZN, GRN

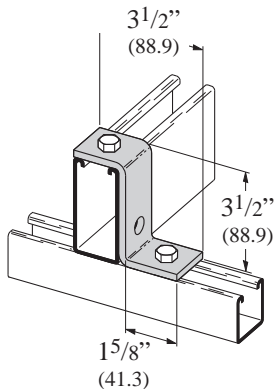

P586
TWO HOLE
Z-SUPPORT

•Standard finishes: ZN, GRN

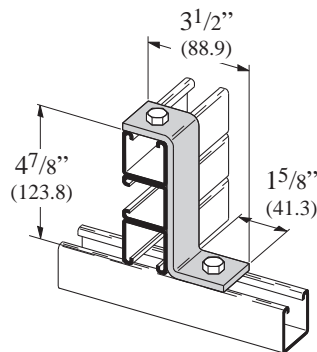

P108
TWO HOLE
OFFSET Z-SUPPORT

•Standard finishes: ZN, GRN

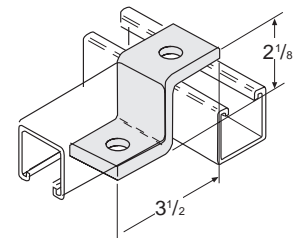

Z-FITTINGS

P387 TWO HOLE Z-BUS DUCT CONNECTION

•Standard finishes: ZN, GRN

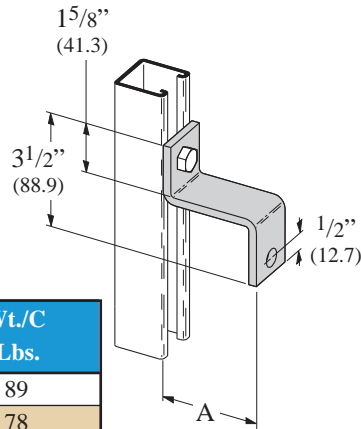

Part No.	A	Wt./C Lbs.
P387	4 ³ / ₄ "	89
P387-1	3 ²⁵ / ₃₂ "	78
P387-2	2 ¹³ / ₃₂ "	62

P407 TWO HOLE Z-SUPPORT

•Standard finishes: ZN, GRN

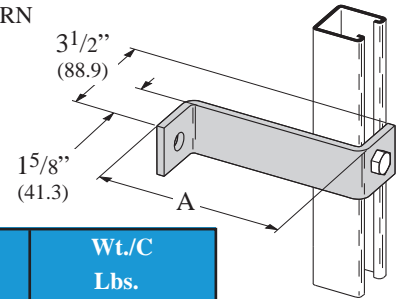

Part No.	A	Wt./C Lbs.
P407-4	4"	77
P407-5	5"	95
P407-6	6"	98
P407-7	7"	105
P407-8	8"	120
P407-9 ⁵ / ₈ "	9 ⁵ / ₈ "	138

P534 TAPPED Z-SUPPORT

•Standard finishes: ZN

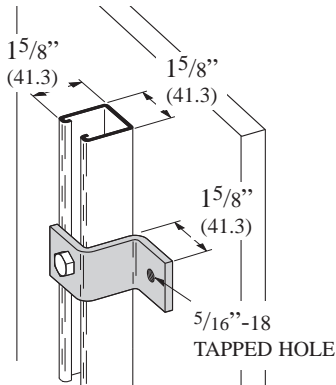

P535 TAPPED Z-SUPPORT

•Standard finishes: ZN

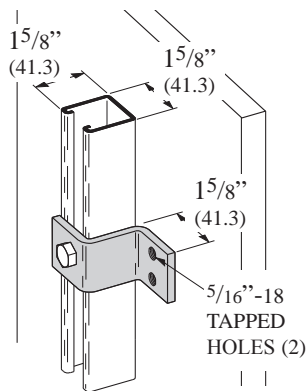

P111 THREE HOLE SHEATH CORNER CONNECTION

•Standard finishes: ZN, GRN

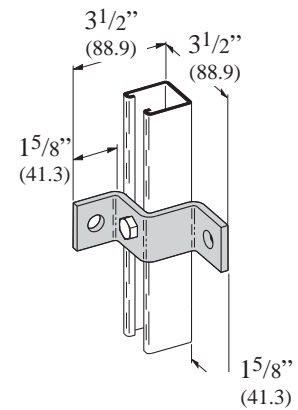

P538 TAPPED CORNER CONNECTION

•Standard finishes: ZN

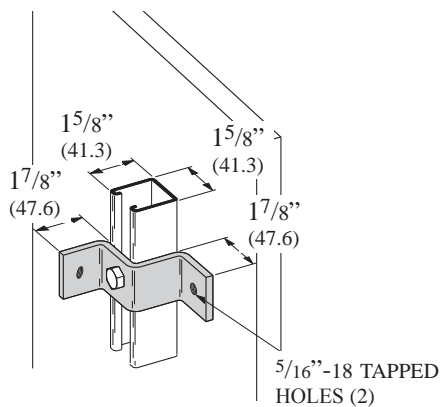

P539 TAPPED CORNER CONNECTION

•Standard finishes: ZN

